

Boehringer  
Ingelheim

Revision .....	1	Type/Size .....	Carton / 62.5 mg
Operator .....	hal	Drawing .....	DCx12
Date .....	06Oct15	Dimensions .....	108.5 x 88 x 199 mm
Art # .....	472203-00	Mkt .....	US
Hpl Item Code ..	51715963	PDF .....	06Oct15 hal
Product .....	PolyMast		

BLACK  
PMS 072  
PMS 604  
VARNISH FREE



Exp  
Lot

**PolyMast™**  
(hetacillin potassium)  
**Intramammary Infusion**  
Equivalent to 62.5 mg ampicillin  
**Caution:** Federal law restricts this drug to use by or on the order of a licensed veterinarian.  
For lactating cows only  
**Net Contents:** 12 x 10 mL syringes

51715963

NDC 0010-4722-02

**PolyMast™**  
(hetacillin potassium)  
**Intramammary Infusion**

Equivalent to 62.5 mg ampicillin  
**Caution:** Federal law restricts this drug to use by or on the order of a licensed veterinarian.  
For lactating cows only  
**Net Contents:** 12 x 10 mL syringes  
NADA 055-054, Approved by FDA

Each 10 mL syringe contains 62.5 mg of ampicillin activity as hetacillin potassium. This product was manufactured by a non-sterilizing process. This carton contains 12 alcohol pads.

**Dosage:** One syringe per affected quarter each 24 hours for a maximum of 3 treatments. See package insert for additional dosage recommendations.

**Residue Warnings:** Milk taken from dairy animals within 72 hours after the latest treatment for mastitis must not be used for food.

Treated animals must not be slaughtered for food until 10 days after the latest treatment.

Do not store above 25°C (77°F).  
Do not freeze.

472203-00  
Made in Italy



Manufactured for:  
**Boehringer Ingelheim Vetmedica, Inc.**  
St. Joseph, MO 64506 U.S.A.

NDC 0010-4722-02

**PolyMast™**  
(hetacillin potassium)  
**Intramammary Infusion**

Equivalent to 62.5 mg ampicillin  
**Caution:** Federal law restricts this drug to use by or on the order of a licensed veterinarian.  
For lactating cows only  
**Net Contents:** 12 x 10 mL syringes  
NADA 055-054, Approved by FDA

**Directions for use of Opti-Sert® Protective Cap - Partial or Full Insertion**

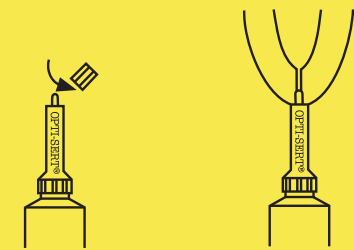

**Partial Insertion:**  
Twist off the upper portion of the Opti-Sert Protective Cap to limit depth of insertion into the teat canal.

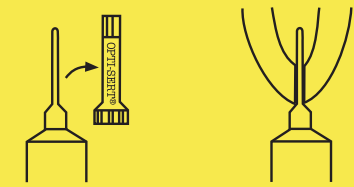

**Full Insertion:**  
Remove the entire Opti-Sert Protective Cap for full insertion into the teat canal.

Opti-Sert is a registered trademark of Zoetis W LLC - used under license.

PolyMast is a trademark of Boehringer Ingelheim Vetmedica GmbH, used under license.

© 2015 Boehringer Ingelheim Vetmedica, Inc. All rights reserved.



DCx12